

**Item Title:** Conveyance of an Easement at South Wake Landfill to Duke Energy Progress, LLC

**Specific Action Requested:**  
**That the Board of Commissioners:**

- 1. Approves the conveyance of an easement at South Wake Landfill to Duke Energy Progress, LLC; and**
- 2. Authorizes the Chair to execute said deed of easement document (along with any other supporting documentation), subject to the terms and conditions acceptable to the County Attorney.**

**Item Summary:**

**Purpose:** The Board of Commissioners must approve all real estate transactions, including easements conveyed by the County.

**Background:** In July 2017 the Wake County Board of Commissioners approved the conveyance of a Temporary Construction Easement to the North Carolina Department of Transportation for the U-5118 NC 55 Bypass project at the intersection of Sportsmanship Way. As part of this road project, a turnaround has been constructed on the NC 55 Bypass to allow for a signalized U-Turn for vehicles wishing to head southbound. Duke Energy is now requesting an underground easement to serve the traffic control cabinet within the NCDOT right of way.

**Board Goal:** This action supports standard County operations.

**Fiscal Impact:** There is no fiscal impact to the County associated with this easement conveyance.

**Additional Information:**

In October of 2019 the County received the attached letter from Duke Energy requesting an easement from Wake County for the installation of an underground service line from the existing pole number 96C68 to serve a traffic control cabinet within the NCDOT right of way. The existing pole is located on the eastern boundary of the South Wake Landfill property, approximately 16 feet off the NC 55 Bypass existing right of way. The proposed easement is 10 feet on either side of the existing Duke infrastructure. The map below shows the location of the proposed easement, existing pole, and traffic control box within the existing right of way. A more detailed map is attached which is labeled as "Exhibit A".

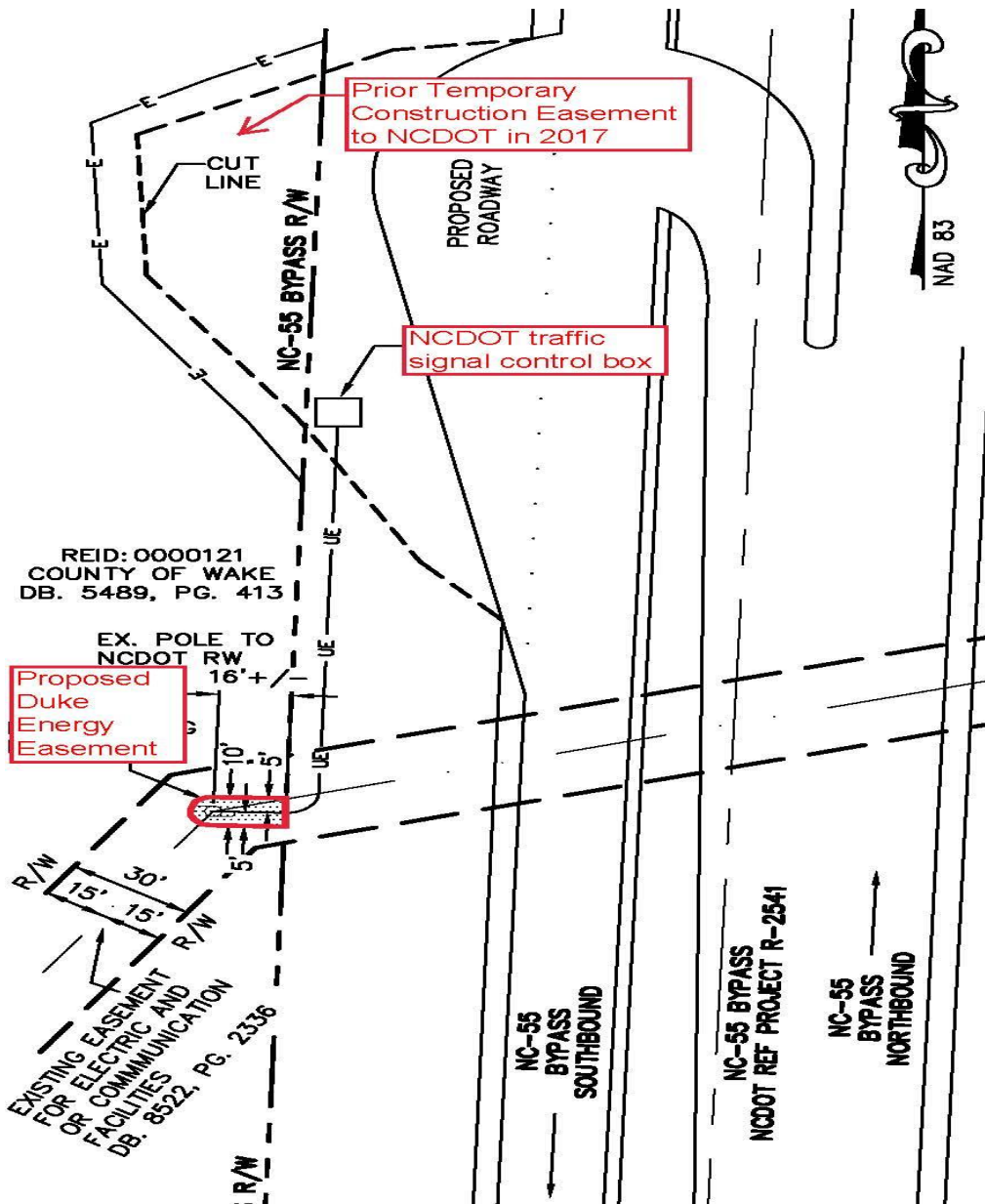

The location of this proposed easement has been reviewed by County staff from Wake County Environmental Services Solid Waste Management Division and Facilities Design & Construction to determine the easement's impact on the future use of the property. Due to the existing Duke Energy easement, size of the property and location of the proposed easement, staff has determined the conveyance will have no negative impact on the County's value or use of the property. Staff recommends approval of the conveyance subject to terms and conditions acceptable to the County Attorney.

#### **Attachments:**

1. Easement Request October 2019
2. Duke Energy Easement
3. Exhibit A