



WAKE COUNTY
PUBLIC SCHOOL SYSTEM

Community Responsive Schools - Proposed Partnership

- WCPSS
- YMCA
- Southeast Raleigh Promise

Wake County Board of Commissioners Public Education and Human Services Committee
Meeting – September 14, 2016

CATHY MOORE, WCPSS DEPUTY SUPERINTENDENT FOR ACADEMIC ADVANCEMENT
KIA BAKER – SOUTHEAST RALEIGH PROMISE
JON MILLES – YMCA OF THE TRIANGLE



WAKE COUNTY
PUBLIC SCHOOL SYSTEM

Goals for today's meeting

- Provide overview of potential partnership, vision and need
- Provide overview of Southeast Raleigh Promise
- Provide overview of YMCA Southeast Raleigh Branch location and preliminary facility/site plans

Cathy Moore, WCPSS

Kia Baker, Southeast Raleigh Promise

Jon Mills, YMCA of the Triangle



Elementary Schools:

Future CIP Acquired Sites
E45, E50, E24, E35, E44 &
Target Circles

Update March, 2016

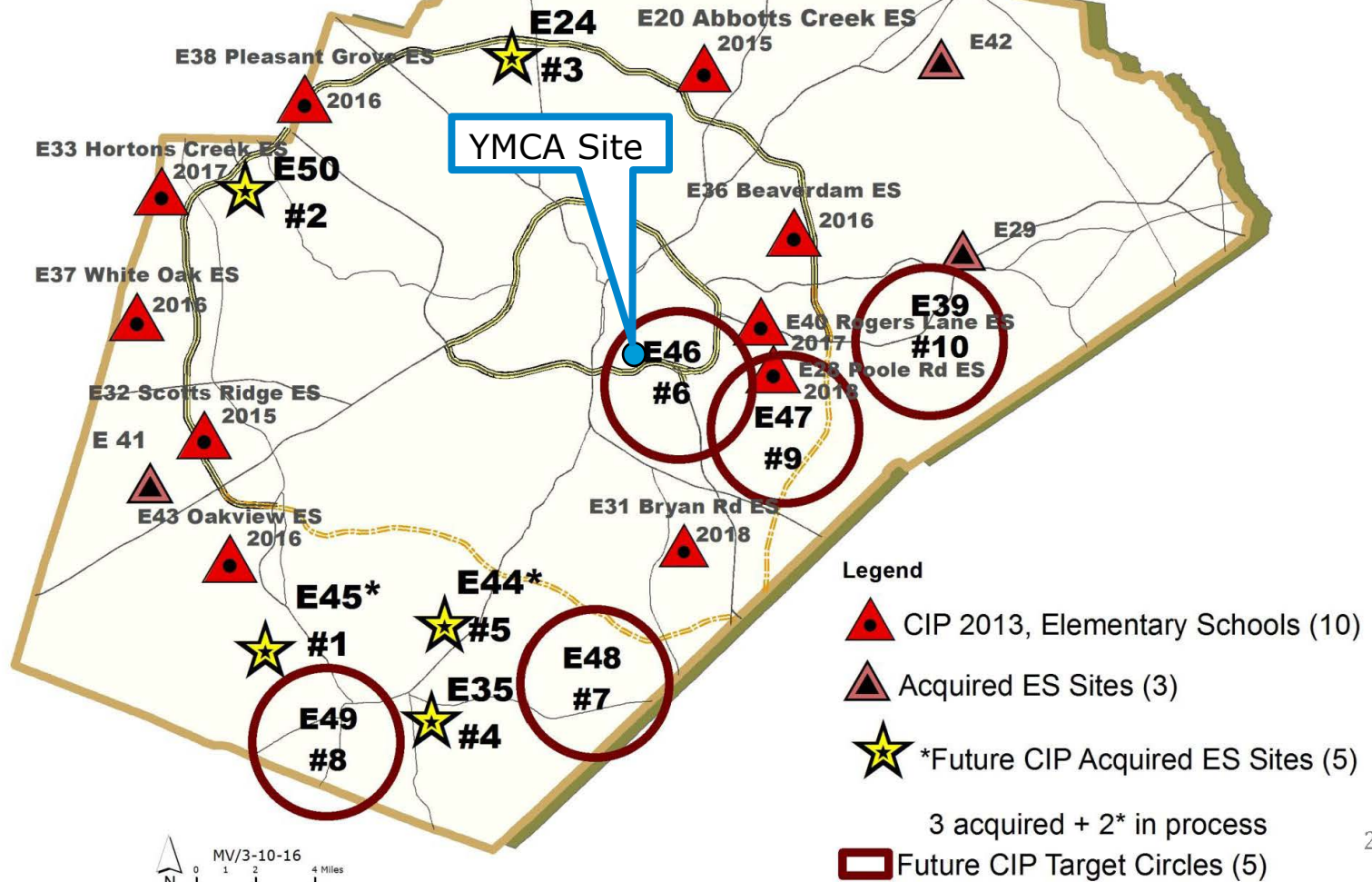



Basis for early discussions

- WCPSS has an interest in identifying school models and partnerships that are driven by the WCPSS Strategic Plan and community needs
- WCPSS has a strong relationship and history of collaboration with the YMCA of the Triangle
- WCPSS and the YMCA first discussed a possible partnership about two years ago
- WCPSS achievement data shows that there is a need and opportunity for targeted work in the Southeast Raleigh area

Percent of Students who Scored Proficient in Reading in 2014-15 Grades 3 to 5

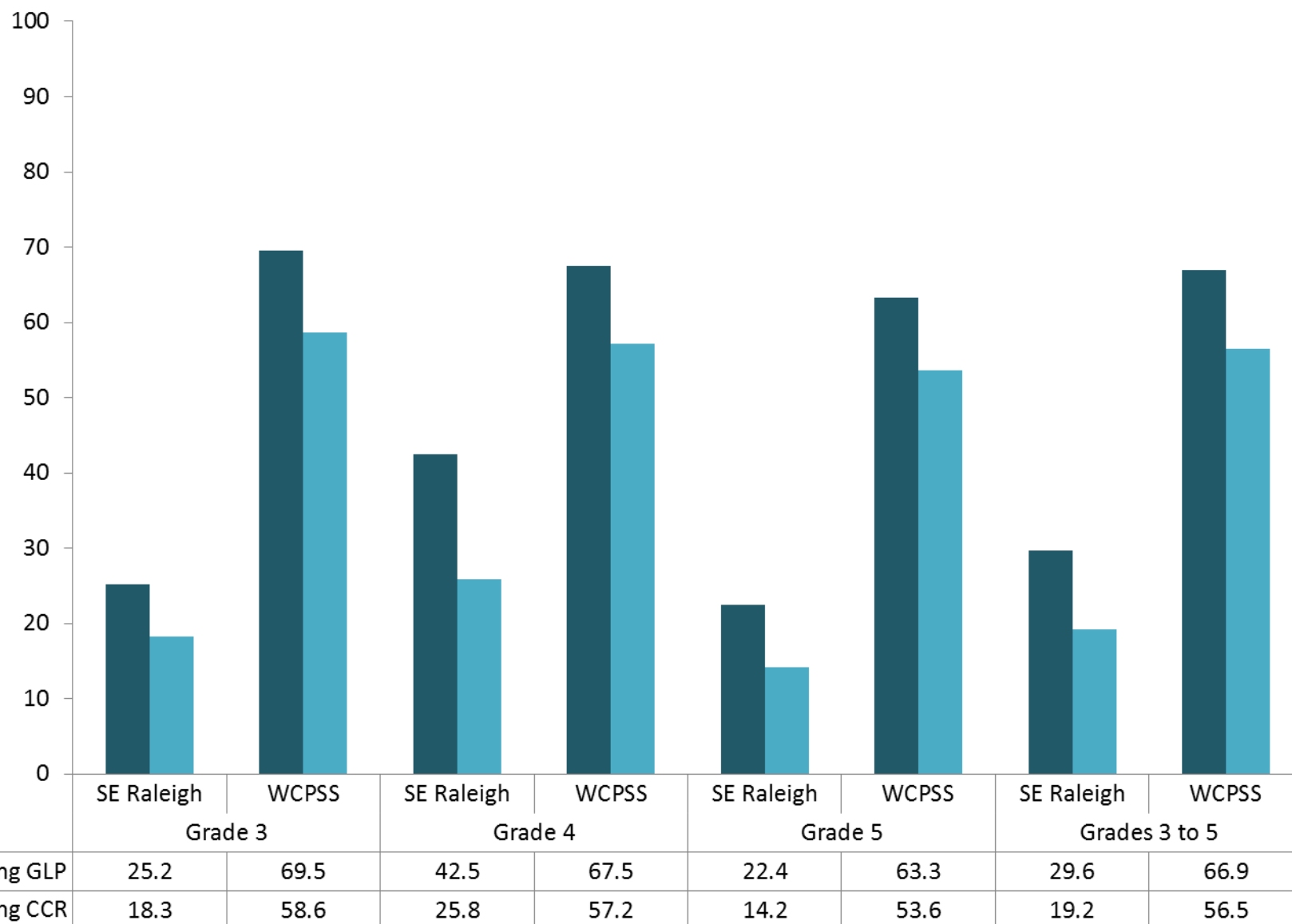

Percent of Students who Scored Proficient in Math in 2014-15 Grades 3 to 5

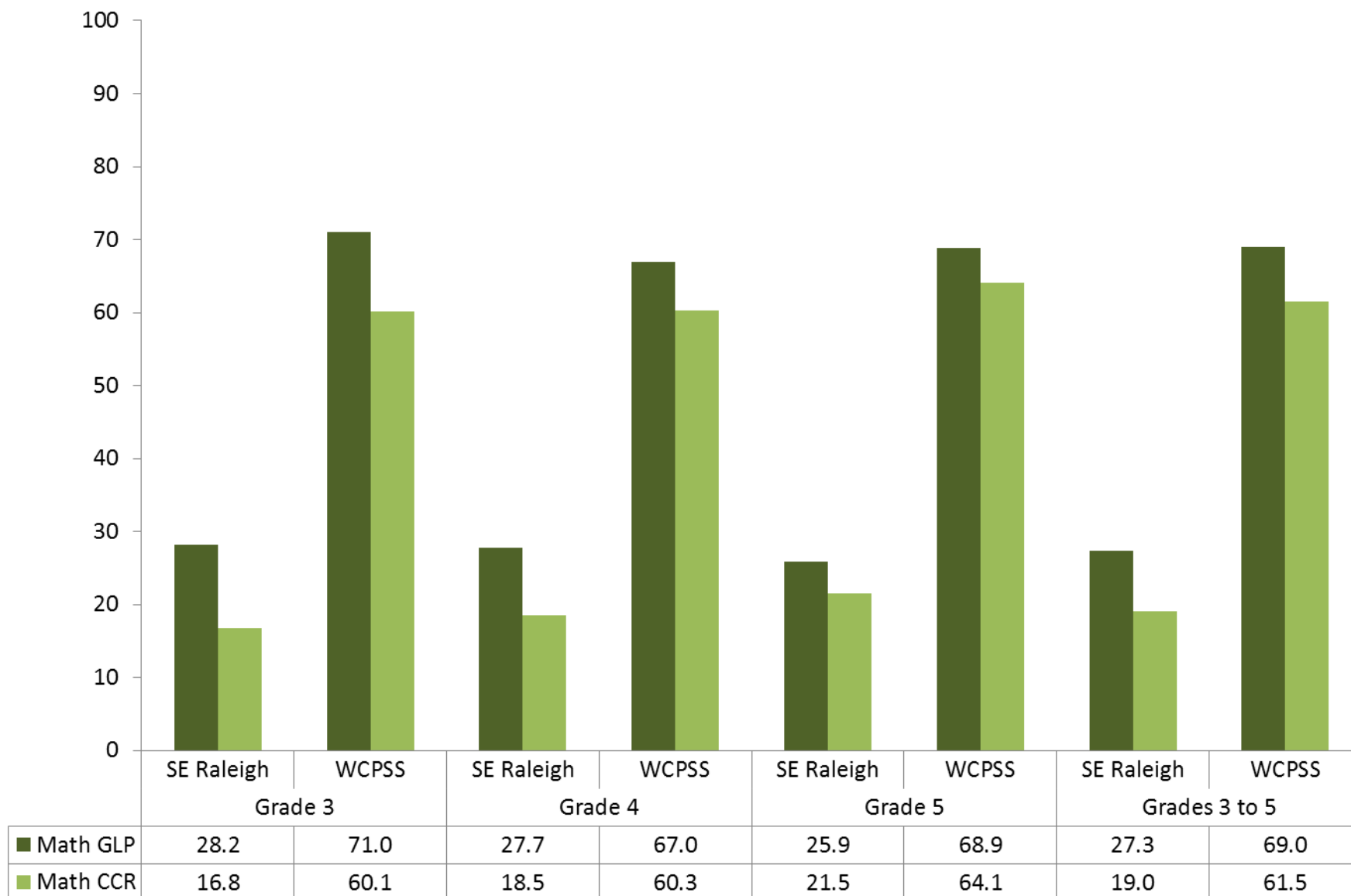

Percent of Juniors who met the State Benchmark for College Readiness 2014-15

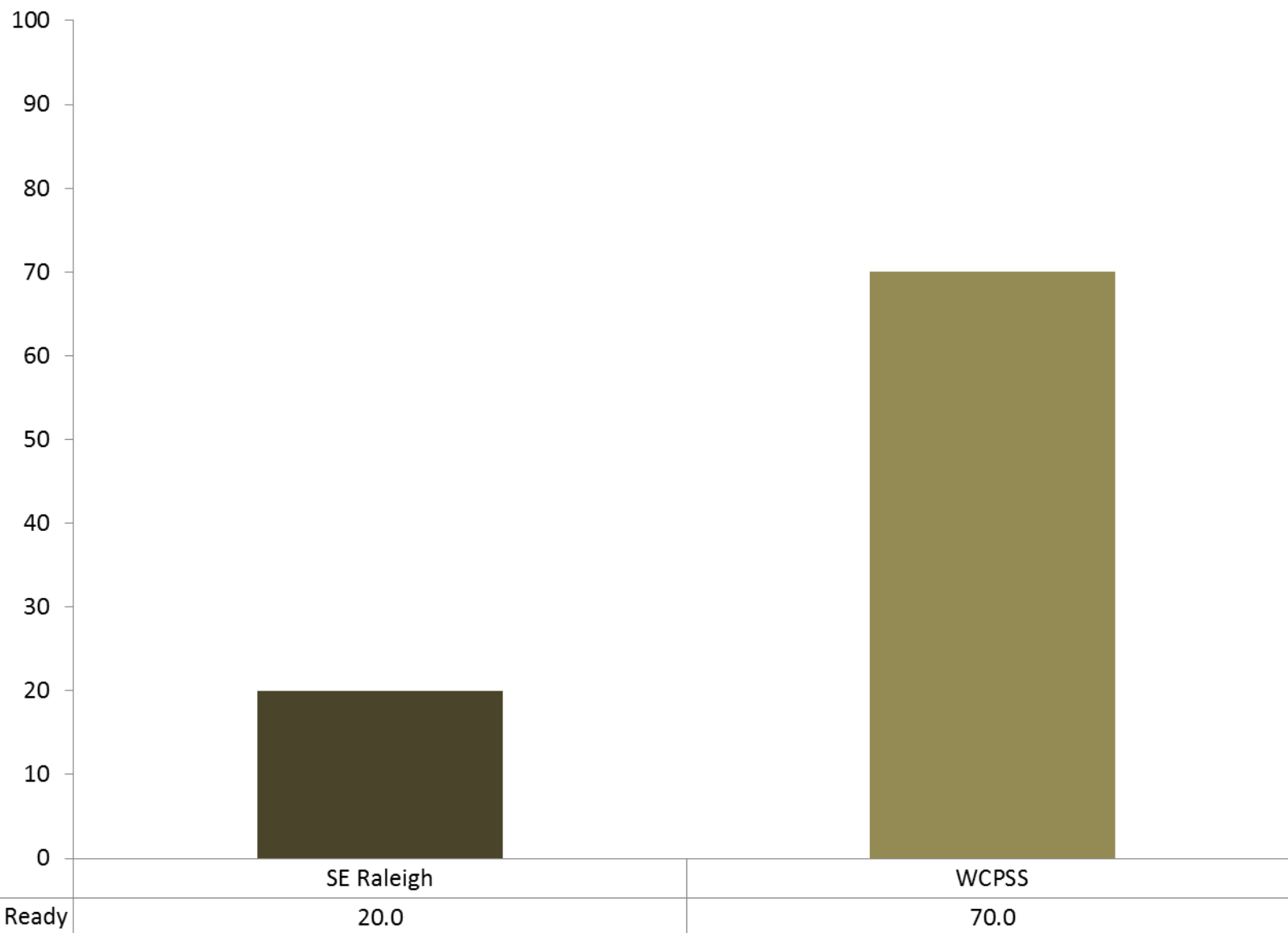

WCPSS Vision 20/20

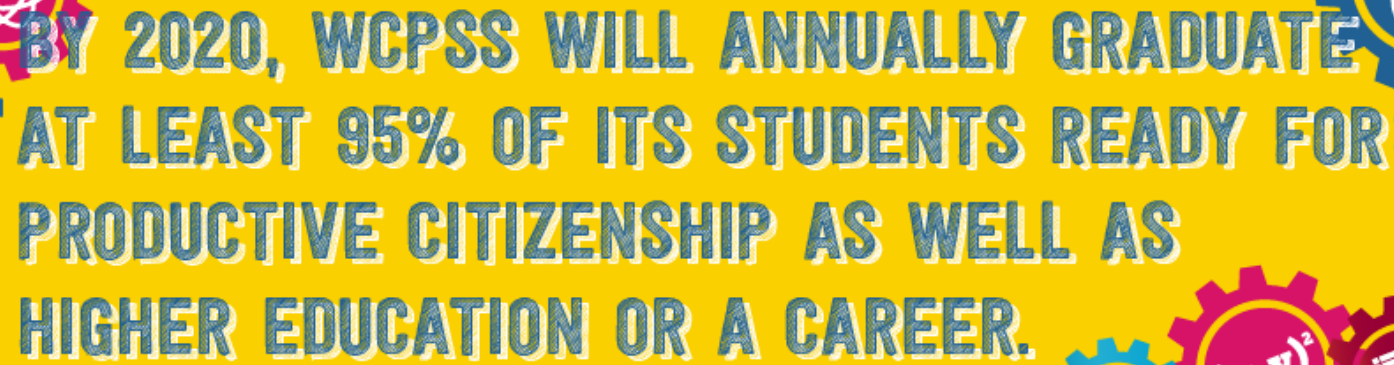
A yellow banner with a decorative border of colorful gears (red, blue, green) and icons (atom, beaker, pencil, book, and the equation $(x-y)^2$). The text is in a bold, blue, sans-serif font with a white outline.

**BY 2020, WCPSS WILL ANNUALLY GRADUATE
AT LEAST 95% OF ITS STUDENTS READY FOR
PRODUCTIVE CITIZENSHIP AS WELL AS
HIGHER EDUCATION OR A CAREER.**

WCPSS Community Engagement Goal

To foster shared responsibility for student success by building trust, collaboration, and engagement among staff, families and community partners



SOUTHEAST RALEIGH PROMISE

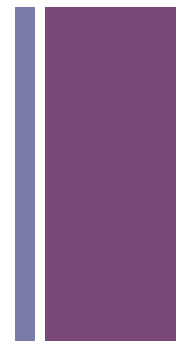

**A community initiative to end the cycle of
intergenerational poverty.**



PURPOSE
BUILT
COMMUNITIES

Changing neighborhoods. Changing lives.

+ The Approach

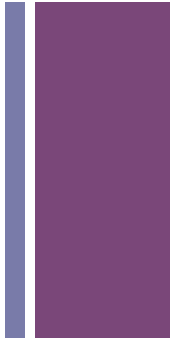

- Collective Impact
- Place-Based
- Adaptive & Responsive
- Equity through Access & Residential Leadership



The Model



PURPOSE BUILT COMMUNITIES MODEL

- **Defined Neighborhood:** focus on defined neighborhoods. If we can change the place, we can change outcomes for the people who live there.
- **Community Quarterback:** leads the revitalization by engaging community members, building partnerships, securing funding, and ensuring implementation of all components of the model as part of the community's vision
- **Mixed-Income Housing:** offer an environment with high-quality construction and practical amenities, transforming the way residents view themselves and their neighborhood.
- **Cradle-to-College Education:** create an integrated education pipeline that provides seamless handoffs between early learning, K-12 and afterschool programs to help ensure successful futures through college and beyond.
- **Community Wellness:** provide a community-specific mix of facilities, programs, and services that honor local history, reflect the priorities of residents, promote healthy lifestyles, create jobs and reduce crime.



The Model

Building on the Purpose Built Communities model, Southeast Raleigh Promise will address 5 Pillars for strategic investments:



- Education (from birth to career)
- Affordable Housing
- Health & Wellness
- Economic Opportunity
- Leadership Development



The Place- Area of Investment

The “Beacon Site” along Rock Quarry Road will include a YMCA, Affordable Housing, Elementary School, and Multi-Use Flex space.

PLAN KEY

- 1 SCHOOL COMPONENT (28,000 SF)
- 2 YMCA (26,000 SF)
- 3 GROCER (10,000 SF)
- 4 MEDICAL (15,000 SF)
- 5 SHELTER / RESTROOMS
- 6 POOL HOUSE
- 7 RESIDENTIAL HOUSING (80 UNITS)





The Place- Area of Impact

The initiative will focus in the areas of Southeast Raleigh with the highest rates of poverty.

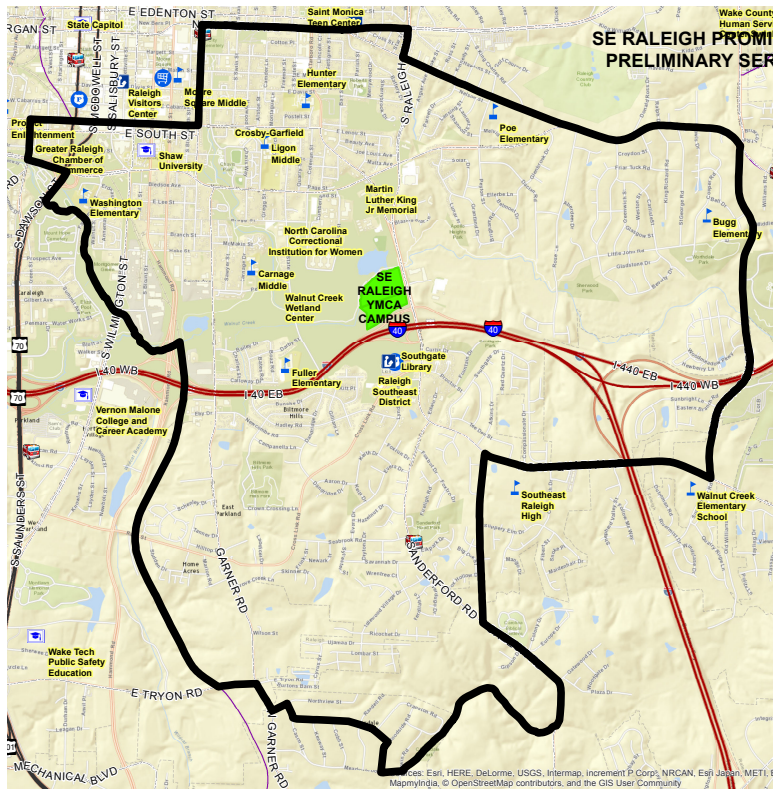

- 6 census tracts surrounding the beacon site along the Rock Quarry Rd. Corridor
- Approximately 29,000 residents live in this area. Approximately 7,900 of them are children under the age of 18. 54.1% of them live in poverty.
- In 2014-15, 19.2% of 3rd-5th grade students who live in the zone scored proficient in reading (CCR) and 19% in math(CCR).



The Outcome

We will break the cycle of intergenerational poverty when...



- All children within the “zone” obtain an education that ensures social connectivity, self-efficacy, and a postsecondary credential with labor market value.
- All residents within the “zone” strengthen spirit, mind, & body, and obtain health and wellbeing through quality health care, nutritious food, and physical activity.
- All children and their families within the “zone” have dignified, safe, and affordable housing.
- We create economic opportunities within the “zone” and connect Southeast Raleigh youth and families to employment, entrepreneurship, and economic advancement.
- We prepare youth and their families within the “zone” to be positive agents of change with the skills necessary to drive individual and community long-term success.

YMCA/Elementary School
Preliminary Concept Plan

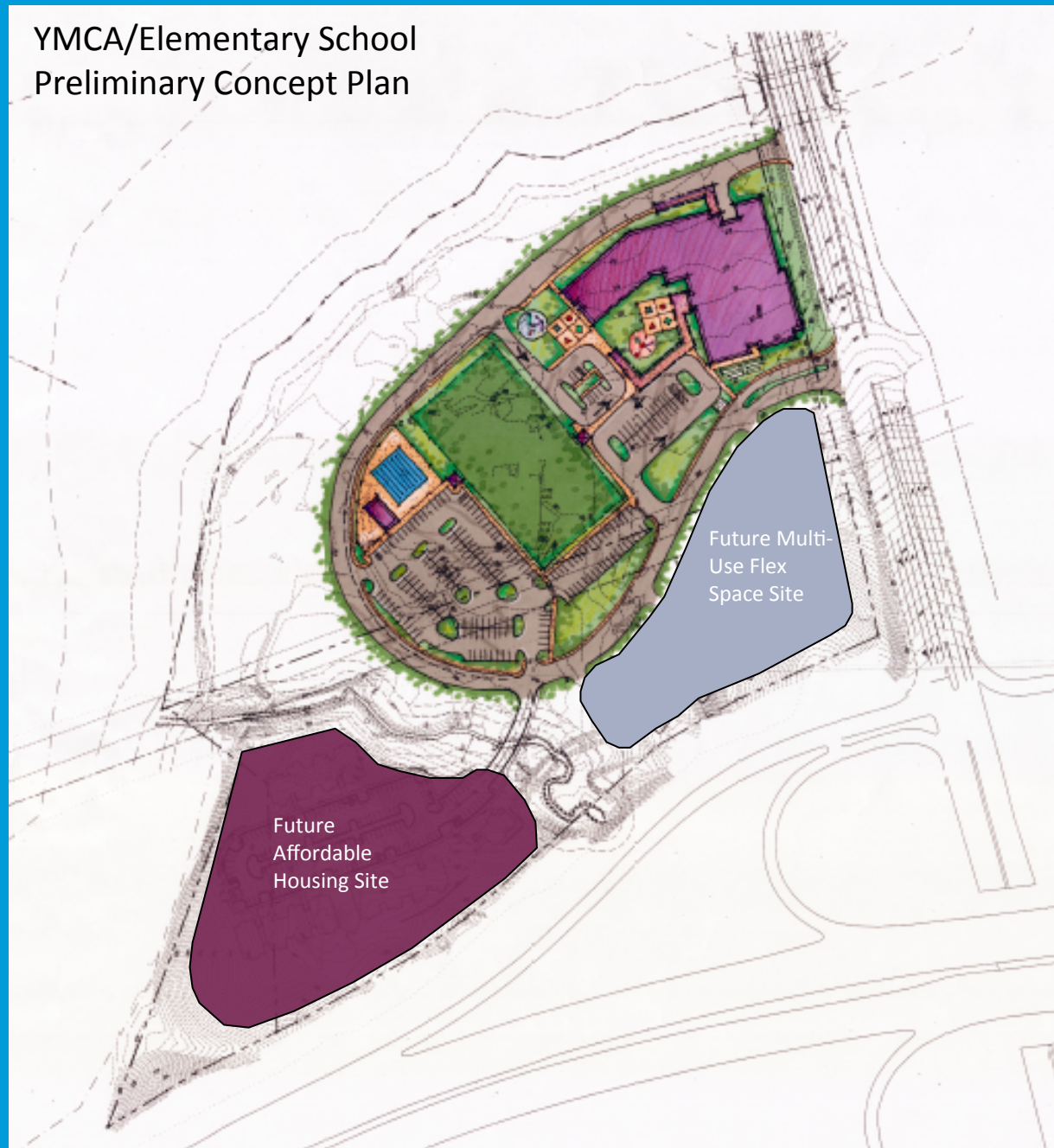

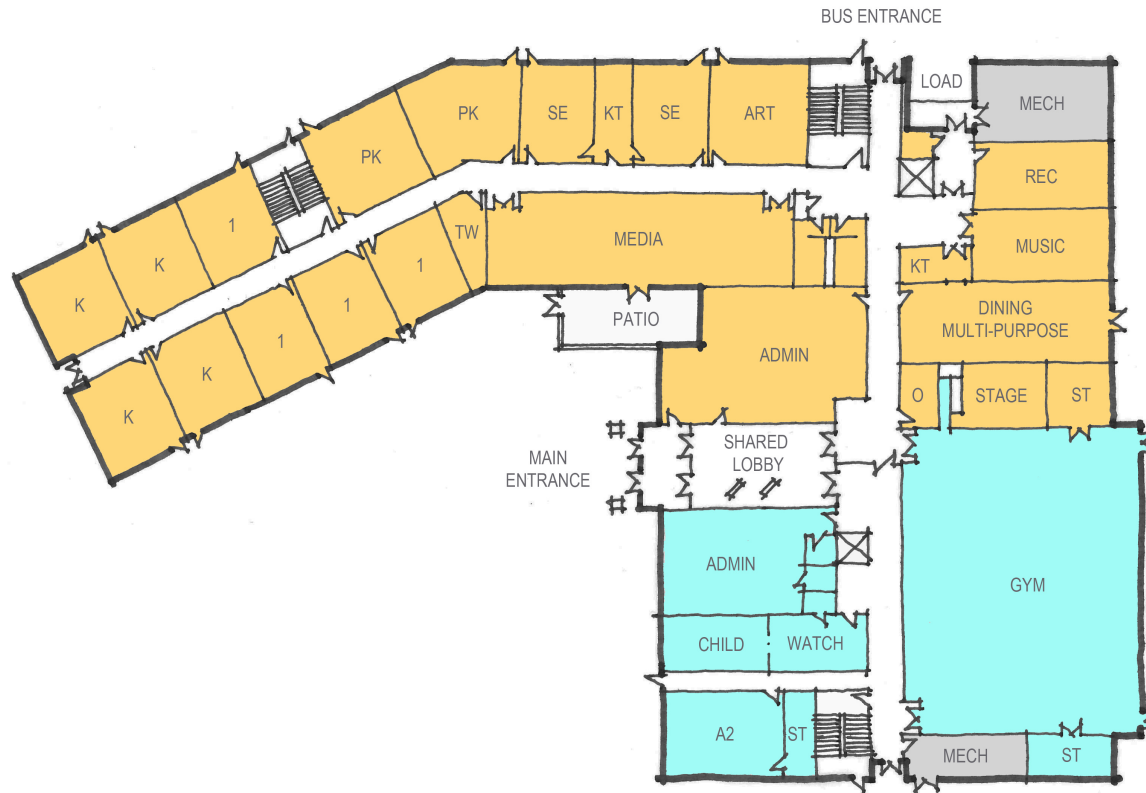



 WCPSS ELEMENTARY SCHOOL PROGRAM

 YMCA PROGRAM

SE RALEIGH PROMISE PROJECT
YMCA & WCPSS ELEM SCHOOL



FLOOR PLANS
6.1.16



CONCEPT 5 - SECOND FLOOR PLAN

SCALE: 1" = 40'-0"
500 STUDENT ELEMENTARY SCHOOL



WCPSS ELEMENTARY SCHOOL PROGRAM

YMCA PROGRAM

SE RALEIGH PROMISE PROJECT
YMCA & WCPSS ELEM SCHOOL



FLOOR PLANS
6.1.16



CONCEPT 5 - THIRD FLOOR PLAN

SCALE: 1" = 40'-0"
500 STUDENT ELEMENTARY SCHOOL



Next Steps

- Finalize a Memorandum of Understanding (MOU) between the WCPSS BOE and the YMCA that outlines the details of the partnership (targeted by Oct. 31)
 - Create a Leadership Committee to include community stakeholders and thought partners to develop a timeline and priorities (first meeting held Sept. 9)
 - Develop a working calendar for Academic Programming Process considerations and planning for opening in Fall 2019
-



WAKE COUNTY
PUBLIC SCHOOL SYSTEM

Community Responsive Leadership Committee

- Initial meeting – Friday, September 9, 2016
 - Establish working calendar for leadership team
 - Review priorities, sub-committee work
 - Educational Model
 - Attendance Zone/Neighborhood
 - Governance
 - Staffing
 - Operations
 - Partnerships
 - Timeline, next steps
-



WAKE COUNTY
PUBLIC SCHOOL SYSTEM

Questions?
