

NC Grid  
NAD83 (2011)  
North= 768066.80 Ft  
East= 2052181.36 Ft

PIN: 0756283630  
Concourse Lakeside I & II, LLC  
DB 16911 Pg 1420  
BM 1997 Pg 1120  
BM 1997 Pg 1360

PIN: 0756186480  
WAKE COUNTY,  
Wake County Attorney's Office  
DB 2394 Pg 664  
(DB 2235 Pg 2)

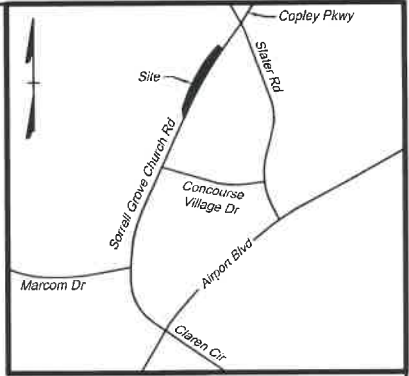

Vicinity Map - Not to Scale

Line Table		
Line	Bearing	Length
L14	N85°02'32"E	18.26'
L15	S29°21'59"W	28.13'
L16	S25°46'32"W	25.30'
L17	S24°54'02"W	425.41'
L18	S19°14'28"W	15.85'
L19	S25°01'05"W	47.27'
L20	N15°23'41"E	35.22'
L21	N23°23'16"E	198.49'
L22	N55°39'41"E	11.33'
L23	N24°27'50"E	238.37'
L24	N36°00'43"W	6.90'
L25	N22°58'36"E	48.12'
L26	S25°01'05"W	494.52'

**Legend**

- △ CP - Computed Point
- ⊙ IPF - Iron Pipe Found
- ⊙ IRF - Iron Rod Found
- ⊙ Manhole Sewer
- ⊙ Power Pole
- ==== Back of Curb
- R/W --- Right-of-Way Line
- Sewer Easement
- OHU --- Overhead Utility Line
- Power Easement Line
- Fence Line
- ▨ Temporary Construction Easement Area
- ▨ Permanent Sidewalk Easement Area

**Abbreviations Legend**

- PIN - Parcel Identification Number
- R/W - Right-of-Way
- DB - Deed Book
- BM - Book of Maps
- Pg - Page
- Ft - Feet
- SR - State Road
- P.O.B. - Point of Beginning
- TCE - Temporary Construction Easement
- PSE - Permanent Sidewalk Easement

**Survey Notes:**

- Prepared for Town of Morrisville, NC.
- This property lies in Zone X, not a special flood hazard area per FIRM 3720075600K Panel 0756, effective date July 19, 2022.
- Horizontal control is based on NC State Grid, NAD'83 (2011) as determined by GPS.
- Not all improvements to this property have been shown.
- Area computation is by the coordinate method.
- Names of adjoining owners shown, based on public record, tax records and/or deeds, as of the original date of this plat.
- This survey was completed without benefit of a title search, not all encumbrances and easements may be shown.
- Property shown hereon is subject to all rights-of-way, easements and restrictions of record.
- Approximate Duke Power easement, 20' centered on poles, no record document found.

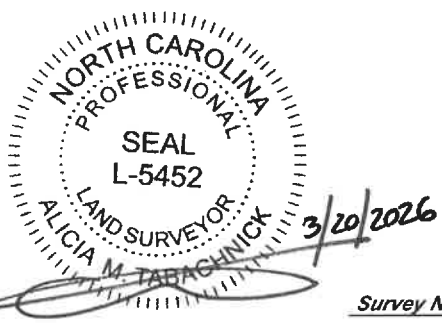

**Sidewalk Easement Exhibit**  
Property of  
**Wake County**  
Sorrell Grove Church Road, North Carolina

Morrisville Township	Wake County
Date: 12/18/2025	Scale: 1" = 50'
Sheet 1 of 1	J.No.: 52084.005
Drawn by: GC	Checked by: AMT
Issued: 2/23/2026 For review & comment	
Issued: Signed & Sealed 3/06/2026	
Issued: Addressed comment, Signed & Sealed 3/20/2026	

This drawing prepared at the **Raleigh Office**

5410 Trinity Road, Suite 102 | Raleigh, NC 27607  
Tel 919.866.4951 Fax 919.859.5663 www.timmons.com  
North Carolina License Number C-1652  
YOUR VISION ACHIEVED THROUGH OURS

