

VICINITY MAP - N.T.S.

| LINE TABLE |               |          |
|------------|---------------|----------|
| LINE       | BEARING       | DISTANCE |
| L1         | S 39°27'36" E | 74.49'   |
| L2         | N 86°54'09" E | 14.81'   |
| L3         | N 86°54'08" E | 5.07'    |
| L4         | S 86°54'08" W | 14.89'   |
| L5         | S 86°54'09" W | 14.81'   |
| L6         | N 39°27'36" W | 44.63'   |
| L7         | N 24°31'41" W | 35.92'   |
| L8         | S 34°47'45" W | 6.44'    |
| L9         | N 37°21'45" E | 29.11'   |
| L10        | S 60°17'31" E | 13.62'   |
| L11        | N 29°16'41" E | 18.75'   |
| L12        | S 60°26'12" E | 28.99'   |
| L13        | S 16°30'39" W | 30.00'   |
| L14        | S 24°31'41" E | 34.67'   |

| CURVE TABLE |         |            |              |               |             |         |
|-------------|---------|------------|--------------|---------------|-------------|---------|
| CURVE       | RADIUS  | ARC LENGTH | CHORD LENGTH | CHORD BEARING | DELTA ANGLE | TANGENT |
| C1          | 35.00'  | 26.23'     | 25.62'       | S 81°29'33" E | 42°56'47"   | 13.77'  |
| C2          | 5.00'   | 2.89'      | 2.85'        | S 76°33'31" E | 33°04'42"   | 1.48'   |
| C3          | 926.47' | 36.85'     | 36.84'       | S 62°03'58" E | 2°16'43"    | 18.43'  |
| C4          | 27.00'  | 25.29'     | 24.38'       | S 60°03'52" W | 53°40'33"   | 13.66'  |
| C5          | 35.00'  | 1.37'      | 1.37'        | S 88°01'27" W | 2°14'36"    | 0.69'   |
| C6          | 836.47' | 32.55'     | 32.55'       | N 62°04'13" W | 2°13'47"    | 16.28'  |
| C7          | 45.00'  | 14.73'     | 14.67'       | N 12°32'04" W | 18°45'24"   | 7.43'   |
| C8          | 87.00'  | 19.62'     | 19.57'       | N 76°58'58" W | 12°55'07"   | 9.85'   |
| C9          | 25.00'  | 20.34'     | 19.78'       | S 11°29'15" W | 46°37'00"   | 10.77'  |
| C10         | 836.47' | 67.57'     | 67.55'       | N 55°04'06" W | 4°37'42"    | 33.80'  |
| C11         | 57.00'  | 27.83'     | 27.55'       | S 74°25'19" E | 27°58'15"   | 14.20'  |
| C12         | 137.00' | 35.82'     | 35.72'       | S 80°54'59" E | 14°58'55"   | 18.01'  |
| C13         | 107.00' | 3.82'      | 3.82'        | N 74°25'53" W | 2°02'51"    | 1.91'   |
| C14         | 35.00'  | 27.50'     | 26.80'       | S 02°14'15" E | 45°01'15"   | 14.50'  |

**LEGEND**

- IPF IRON PIPE FOUND
- ⊙ IRF IRON ROD FOUND
- MONF MONUMENT FOUND
- ▲ SURVEY CONTROL
- CALCULATED POINT
- SURVEYED LINE
- - - NON SURVEYED LINE
- ▨ PROPOSED GREENWAY EASEMENT

**SURVEY CERTIFICATION:**

I, GARRETT J. DORSETT, CERTIFY THAT THIS MAP WAS DRAWN UNDER MY SUPERVISION FROM AN ACTUAL SURVEY MADE UNDER MY SUPERVISION; THAT ANY BOUNDARIES NOT SURVEYED ARE INDICATED WITH BROKEN LINES AND DRAWN FROM INFORMATION IN THE REFERENCES SHOWN HEREON; THAT THE RATIO OF PRECISION OR POSITIONAL ACCURACY AS CALCULATED IS 1:10,000 OR HIGHER AND THIS MAP MEETS THE REQUIREMENTS OF THE STANDARDS OF PRACTICE FOR LAND SURVEYING IN NORTH CAROLINA (21 NCAC 56.1600).

I, FURTHER, CERTIFY THAT THIS MAP WAS DRAWN UNDER MY SUPERVISION FROM AN ACTUAL GPS SURVEY MADE UNDER MY SUPERVISION AND THE FOLLOWING INFORMATION WAS USED TO PERFORM THE SURVEY:

- (1) CLASS OF SURVEY: "AA"
  - (2) POSITIONAL ACCURACY: <0.10'
  - (3) TYPE OF GPS FIELD PROCEDURE: VRS NETWORK
  - (4) DATES OF SURVEY: JANUARY-JUNE 2025
  - (5) DATUM/EPOCH: NAD83(2011)/2010.0000
  - (6) PUBLISHED/FIXED CONTROL USED: VRS NETWORK
  - (7) GEOID MODEL: GEOID18
  - (8) COMBINED GRID FACTOR: 0.999919270 (GROUND TO GRID)
  - (9) UNITS: US SURVEY FEET
- PROJECT LOCALIZED AROUND GPS#1  
(N:766991.684, E:2099779.129, ELEV:284.08)

WITNESS MY ORIGINAL SIGNATURE, REGISTRATION LICENSE NUMBER AND SEAL THIS 3RD DAY OF APRIL A.D., 2026.

Signed by:

*Garrett J. Dorsett*

B8DEF9ED722242E

PROFESSIONAL LAND SURVEYOR LICENSE # L-5351

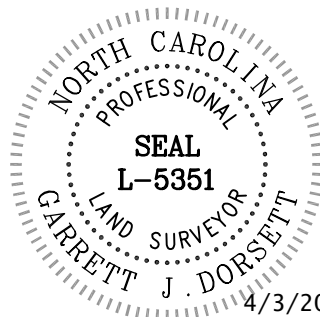

4/3/2026

**EASEMENT EXHIBIT FOR:**  
**MINE CREEK TRAIL IMPROVEMENTS**  
 PROPERTY OF:  
**COUNTY OF WAKE (PIN: 1706087302)**  
 CITY OF RALEIGH - WAKE COUNTY - NORTH CAROLINA - APRIL 3, 2026



**Dewberry**<sup>®</sup>  
 Dewberry Engineers Inc.

2610 WYCLIFF ROAD  
 SUITE 410  
 RALEIGH, NC 27607  
 PHONE: 919.881.9939  
 FAX: 919.881.9923  
 NCBELS # F-0929

PROJECT #: 50185045

**NOTES:**

1. HORIZONTAL CONTROL IS NORTH CAROLINA STATE PLANE COORDINATE SYSTEM NAD83, ESTABLISHED BY GPS OBSERVATIONS AND COMPUTED USING NORTH CAROLINA GEODETIC SOCIETY VIRTUAL REFERENCE STATION SERVICE (VRS).
2. AREA COMPUTED BY COORDINATE METHOD.
3. ALL DISTANCES SHOWN ON THIS EXHIBIT ARE GROUND DISTANCES UNLESS OTHERWISE NOTED.
4. REFERENCES SHOWN HEREON.
5. DASHED LINES ARE NOT SURVEYED.
6. THE INFORMATION CONTAINED HEREON IS SUBJECT TO THE FINDINGS OF A COMPLETE AND ACCURATE OPINION OF TITLE, AND TO THOSE EXCEPTIONS AND EASEMENTS OF RECORD, IF ANY, NOTED THEREON.

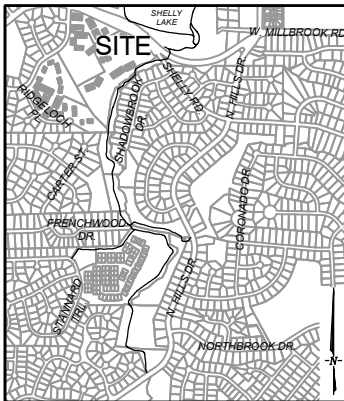

VICINITY MAP - N.T.S.

**LEGEND**

- IPF IRON PIPE FOUND
- ⊙ IRF IRON ROD FOUND
- MONF MONUMENT FOUND
- ▲ SURVEY CONTROL
- CALCULATED POINT
- SURVEYED LINE
- - - NON SURVEYED LINE
- ▨ PROPOSED GREENWAY EASEMENT

GPS#2  
GRID  
REBAR & CAP  
N:766991.684  
E:2099779.129

APPROX. LOCATION OF  
40' UTILITY EASEMENT  
BM 1973 PG 219  
S 44°01'03" E 685.53'  
GROUND TIE  
CSF = 0.999919792.

R/W MONF R&C  
LOCALIZED GROUND  
N:766498.70  
E:2100255.49

**PROPOSED  
30' GREENWAY  
EASEMENT #1  
6,170 SF**

**PROPOSED  
GREENWAY**

**PROPOSED  
30' GREENWAY  
EASEMENT #2  
1,654 SF**

COUNTY OF WAKE  
PIN 1706087302  
DB. 2394 PG. 664 (TRACT 17)  
DB. 1900 PG. 217  
DB. 1821 PG. 595  
B.M. 1973 PG. 39  
B.M. 1973 PG. 219  
B.M. 1967 PG. 356

APPROX. LOCATION OF  
20' DRAINAGE EASEMENT  
BM 1988 PG 88

WILLIS P. BEAL, III  
& CANDY L. BEAL  
PIN 1706066275  
DB 2150 PG 486  
BM 2009 PG 52

AMANDA E. BEAL  
PIN 1706065217  
DB 19001 PG 893  
BM 2009 PG 52

30' CITY OF RALEIGH  
SANITARY SEWER EASEMENT  
BM 1960 PG 226

N 86°45'48" W 214.84' (TIE)

NC GRID (NAD 83/2011)

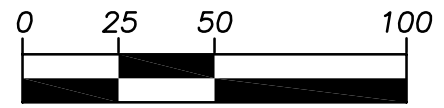

1 INCH = 50 FEET

Signed by:

Garrett J. Dorsett

B8DFE9FD722242E

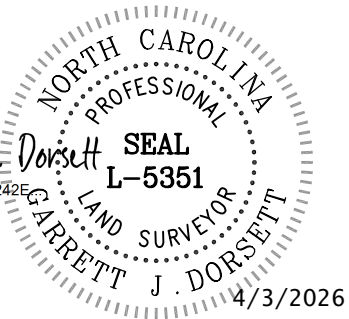

**EASEMENT EXHIBIT FOR:  
MINE CREEK TRAIL IMPROVEMENTS**

PROPERTY OF:  
**COUNTY OF WAKE (PIN: 1706087302)**  
CITY OF RALEIGH - WAKE COUNTY - NORTH CAROLINA - APRIL 3, 2026



**Dewberry**<sup>®</sup>  
Dewberry Engineers Inc.

2610 WYCLIFF ROAD  
SUITE 410  
RALEIGH, NC 27807  
PHONE: 919.881.9939  
FAX: 919.881.9923  
NCBELS # F-0929

PROJECT #: 50185045

**NOTES:**

1. HORIZONTAL CONTROL IS NORTH CAROLINA STATE PLANE COORDINATE SYSTEM NAD83, ESTABLISHED BY GPS OBSERVATIONS AND COMPUTED USING NORTH CAROLINA GEODETIC SOCIETY VIRTUAL REFERENCE STATION SERVICE (VRS).
2. AREA COMPUTED BY COORDINATE METHOD.
3. ALL DISTANCES SHOWN ON THIS EXHIBIT ARE GROUND DISTANCES UNLESS OTHERWISE NOTED.
4. REFERENCES SHOWN HEREON.
5. DASHED LINES ARE NOT SURVEYED.
6. THE INFORMATION CONTAINED HEREON IS SUBJECT TO THE FINDINGS OF A COMPLETE AND ACCURATE OPINION OF TITLE, AND TO THOSE EXCEPTIONS AND EASEMENTS OF RECORD, IF ANY, NOTED THEREON.