

VICINITY MAP - N.T.S.

**LEGEND**

- IPF IRON PIPE FOUND
- IRF IRON ROD FOUND
- MONF MONUMENT FOUND
- CALCULATED POINT
- SURVEYED LINE
- - - NON SURVEYED LINE
- [Hatched Box] SANITARY SEWER EASEMENT
- [Dotted Box] TEMPORARY CONSTRUCTION EASEMENT
- [Cross-hatched Box] ACCESS EASEMENT
- [Diagonal-hatched Box] EASEMENT TO BE ABANDONED

**EXISTING SANITARY SEWER EASEMENT TO BE DISPOSED OF BY A FUTURE INSTRUMENT**

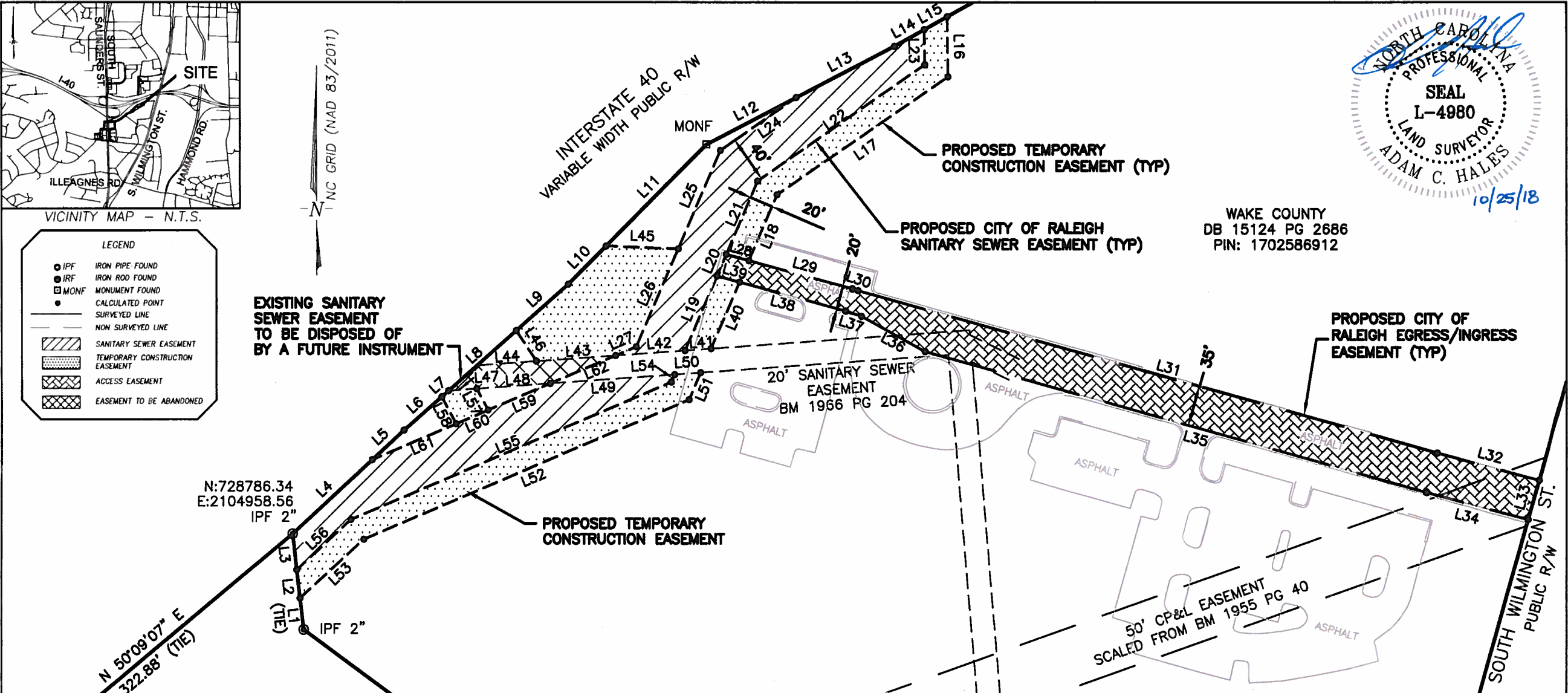

N:728786.34  
E:2104958.56  
IPF 2"

N 50°09'07" E  
322.88' (TIE)

SAMS REAL ESTATE BUSINESS TRUST  
DB 15172 PG 1500  
BM 1992 PG 226  
PIN: 1702487225

MONF

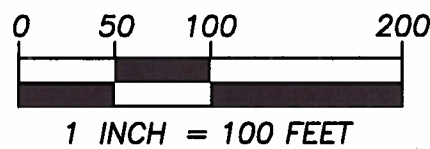

WAKE COUNTY  
DB 15124 PG 2686  
PIN: 1702586912

EASEMENT EXHIBIT FOR AQUISITION PURPOSES:  
**SOUTH SAUNDERS SEWER REPLACEMENT**  
PROPERTY OF:  
**WAKE COUNTY**  
SWIFT CREEK TOWNSHIP - WAKE COUNTY - NORTH CAROLINA - OCTOBER 2018

**Dewberry**  
Dewberry Engineers Inc.  
2810 WYCLIFF ROAD  
SUITE 410  
RALEIGH, NC 27607  
PHONE: 919.881.9909  
FAX: 919.881.9923  
NCBELS # F-0829

- NOTES:**
- HORIZONTAL CONTROL IS NORTH CAROLINA STATE PLANE COORDINATE SYSTEM NAD83, ESTABLISHED BY GPS OBSERVATIONS AND COMPUTED USING NORTH CAROLINA GEODETIC SOCIETY VIRTUAL REFERENCE STATION SERVICE (VRS).
  - AREA COMPUTED BY COORDINATE METHOD.
  - ALL DISTANCES SHOWN ON THIS EXHIBIT ARE GROUND DISTANCES UNLESS OTHERWISE NOTED.
  - REFERENCES SHOWN HEREON.
  - DASHED LINES ARE NOT SURVEYED.
  - THE INFORMATION CONTAINED HEREON IS SUBJECT TO THE FINDINGS OF A COMPLETE AND ACCURATE OPINION OF TITLE, AND TO THOSE EXCEPTIONS AND EASEMENTS OF RECORD, IF ANY, NOTED THEREON.

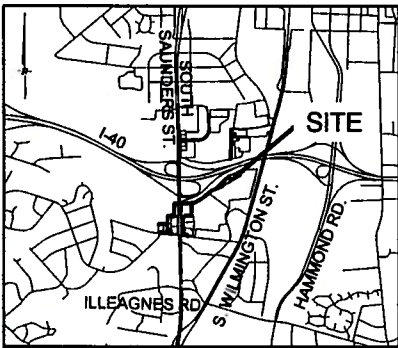

VICINITY MAP - N.T.S.

**LEGEND**

- IPF IRON PIPE FOUND
- IRF IRON ROD FOUND
- MONF MONUMENT FOUND
- CALCULATED POINT
- SURVEYED LINE
- - - NON SURVEYED LINE
- ▨ SANITARY SEWER EASEMENT
- ▩ TEMPORARY CONSTRUCTION EASEMENT
- ▧ ACCESS EASEMENT
- ▦ EASEMENT TO BE ABANDONED

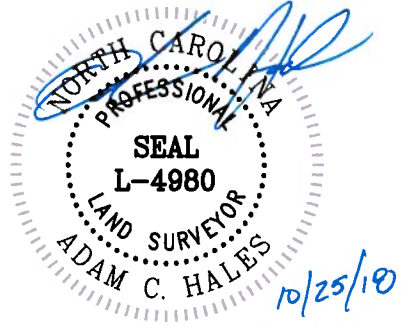

PROPOSED EASEMENT AREA TABLE (TOTAL ALL SHEETS)					
OWNER	SANITARY SEWER	TEMPORARY CONSTRUCTION	EGRESS/INGRESS	EX. SANITARY SEWER (TO BE DISPOSED OF)	TOTAL
WAKE COUNTY	25,471 ± SF	23,812 ± SF	23,144 ± SF	2,083 ± SF	70,344 ± SF

LINE TABLE		
LINE	BEARING	DISTANCE
L1	N 06°35'57" W	27.10'
L2	N 06°35'57" W	24.75'
L3	N 06°35'57" W	31.08'
L4	N 47°09'37" E	93.56'
L5	N 47°09'37" E	37.27'
L6	N 48°27'49" E	43.37'
L7	N 48°27'49" E	7.92'
L8	N 48°27'49" E	78.10'
L9	N 48°27'49" E	60.19'
L10	N 44°42'24" E	46.47'
L11	N 44°42'24" E	123.03'
L12	N 62°33'48" E	87.47'
L13	N 62°33'48" E	95.72'
L14	N 60°41'45" E	29.48'
L15	N 60°41'45" E	22.62'
L16	S 00°38'37" E	51.81'
L17	S 55°29'35" W	179.14'
L18	S 23°17'22" W	61.79'
L19	N 23°16'28" E	69.88'
L20	N 23°16'28" E	20.20'
L21	N 23°16'28" E	69.00'
L22	N 55°15'48" E	175.60'
L23	N 00°39'51" W	30.24'
L24	S 55°15'48" W	79.72'
L25	S 23°16'28" W	92.37'
L26	S 23°16'28" W	91.78'
L27	S 66°53'15" W	19.29'
L28	S 74°48'54" E	20.18'
L29	S 74°48'54" E	92.68'
L30	S 71°27'18" E	5.09'
L31	S 74°21'31" E	518.77'

LINE TABLE		
LINE	BEARING	DISTANCE
L32	S 75°04'49" E	90.62'
L33	S 15°20'41" W	35.00'
L34	N 75°04'49" W	90.58'
L35	N 74°21'31" W	449.13'
L36	N 60°57'31" W	62.67'
L37	N 71°27'18" W	14.43'
L38	N 74°48'54" W	94.94'
L39	N 74°48'54" W	20.18'
L40	S 23°17'22" W	62.40'
L41	S 85°56'01" W	22.47'
L42	S 85°56'01" W	60.01'
L43	S 85°56'01" W	68.52'
L44	S 85°56'01" W	51.55'
L45	S 87°39'55" E	62.22'
L46	N 33°42'46" W	31.66'
L47	N 85°56'01" E	24.42'
L48	N 85°56'01" E	63.81'
L49	N 85°56'01" E	107.60'
L50	N 85°56'01" E	22.48'
L51	S 23°12'14" W	25.40'
L52	S 66°53'10" W	305.09'
L53	S 47°18'21" W	74.92'
L54	S 23°16'28" W	7.09'
L55	S 66°53'15" W	300.53'
L56	S 47°18'21" W	63.79'
L57	N 28°08'22" W	20.90'
L58	S 28°08'22" E	26.39'
L59	S 66°53'15" W	58.49'
L60	S 66°53'15" W	30.12'
L61	S 66°53'15" W	78.54'
L62	S 66°53'15" W	61.29'

EASEMENT EXHIBIT FOR ACQUISITION PURPOSES:  
**SOUTH SAUNDERS SEWER REPLACEMENT**  
 PROPERTY OF:  
**WAKE COUNTY**  
 SWIFT CREEK TOWNSHIP - WAKE COUNTY - NORTH CAROLINA - OCTOBER 2018

**Dewberry®**  
 Dewberry Engineers Inc.  
 2810 WYCLIFF ROAD  
 SUITE 410  
 RALEIGH, NC 27607  
 PHONE: 919.881.5939  
 FAX: 919.881.9923  
 NCBELS # F-0928

- NOTES:**
- HORIZONTAL CONTROL IS NORTH CAROLINA STATE PLANE COORDINATE SYSTEM NAD83, ESTABLISHED BY GPS OBSERVATIONS AND COMPUTED USING NORTH CAROLINA GEODETIC SOCIETY VIRTUAL REFERENCE STATION SERVICE (VRS).
  - AREA COMPUTED BY COORDINATE METHOD.
  - ALL DISTANCES SHOWN ON THIS EXHIBIT ARE GROUND DISTANCES UNLESS OTHERWISE NOTED.
  - REFERENCES SHOWN HEREON.
  - DASHED LINES ARE NOT SURVEYED.
  - THE INFORMATION CONTAINED HEREON IS SUBJECT TO THE FINDINGS OF A COMPLETE AND ACCURATE OPINION OF TITLE, AND TO THOSE EXCEPTIONS AND EASEMENTS OF RECORD, IF ANY, NOTED THEREON.